

SHARP

Be Original.

PureBlend-Series

MIXER & GRINDER



USER MANUAL

Read the instructions carefully before use

WELCOME TO THE SHARP FAMILY!

Thank you for using SHARP PureBlend Series. In order to correctly use and maintain the product, we have specially prepared this manual. We recommend you to read the manual carefully before use and proper preservation for future reference.

This user manual will help you to understand your SHARP Mixer & Grinder, and also help you to identify the salient product components while understanding the product assembly steps and further making you better equipped in using the SHARP Mixer & Grinder. This guide will also enable you to practice basic maintenance steps which will ensure trouble free product experience through proper product utilization.

This manual applies only to SHARP PureBlend Series and SHARP reserves the right of final interpretation. All content mentioned in this manual is only for use and maintenance reference. If you happen to encounter any issues with the product, we request you to please contact our customer care number for further assistance. Hope the SHARP PureBlend Series can make your life stress-free, more convenient and healthier.

If you need any information or assistance, please call us on our number-1800 419 4322 or email us at support@sharp-oa.com.

To know more about our products you can visit our website at In.sharp

Important Safety Instructions:

The use of any electrical appliance requires the following of basic precautionary measures and safety guidelines. Primarily there is danger of injury or death and secondly the danger of damage to the appliance. It is recommended not to use the appliance outdoors.

Mains lead-

- The main cord should reach without straining the connections .
- Do not let the main cord hang over the edge of a worktop where a child could reach it.
- Do not let the cord run across an open space between a low socket and table
- Do not let the cord run across a cooker or toaster or other hot area which might damage the cable.

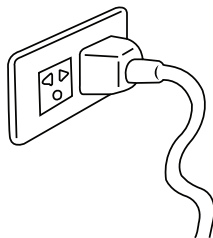

Precautions-

- Keep the Mixer & Grinder at least 150mm away from the wall and on the flat level surface.
- Have sufficient place around the Mixer & Grinder to keep the various items and Ingredients required.
- Don't touch moving pans & blades when the Mixer & Grinder is in operation.
- To protect against electrical hazards, do not immerse any part of the Mixer & Grinder like base, plug or cord in water or any other liquids.
- Never operate your Mixer & Grinder without lid and lid cap.
- Never operate your Mixer & Grinder unless there is load in the jar.
- Do not pull the cord to disconnect, instead grasp the plug and pull to disconnect.
- Always disconnect the plug from the power outlet before cleaning, while emptying and when not in use.
- Do not let the power cord hang over the edge of table/counter or touch any hot surface plug a cord if the plug or cord is damaged, do not use the appliance.

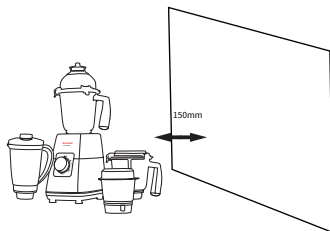

- In the event of any failure of your Mixer & Grinder or cord damaged, do not attempt to repair it at home or allow any unauthorized person to do so. Ensure repairs are carried out only at an authorised SHARP Service Centre.

Children-

- Don't allow children to use this Mixer & Grinder. Children are vulnerable in the kitchen particularly when unsupervised and near running appliances or cooking is being carried out. It is recommended to teach children to be aware of dangers in the kitchen, warn them of the dangers of reaching up to areas where they cannot see properly or should not be reaching.

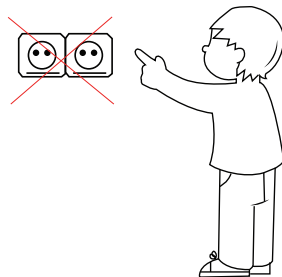

Other Safety Considerations-

- To protect against fire, electric shock and personal injury do not immerse cord, plug or mixer body in water or other liquid.
- Do not operate any appliance with a damaged cord or plug or after the appliance malfunctions or has been damaged in any manner.
- Do not use accessories not recommended by SHARP as there is the danger of fire, electric shock and personal injury.
- Do not place on or near a hot gas or electric burner or in a heated oven.

Electrical requirements-

- Check that the voltage on the rating plate of your appliance corresponds with your house electricity supply which must be AC (Alternating Current).
- If the socket outlets in your home are not suitable for the plug supplied with this appliance, the plug should be removed and the appropriate one should be fitted in order to avoid damage.

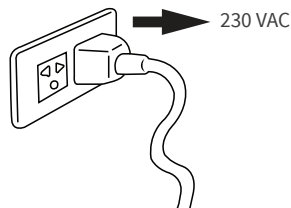

WARNING: The plug removed from the mains cord, if severed, must be destroyed as a plug with bared flexible cord is hazardous if engaged into a live socket outlet.

Assembly

Carefully assemble PureBlend Mixer & Grinder, as blades are very sharp.

WARNING: Make sure that the Mixer & Grinder is switched off and unplugged.

1. Clean the Mixer & Grinder attachments before using it for the first time with damp cloth.
2. Insert the Mixer & Grinder blades into the appropriate jar and turn until locks into position.
3. Place the jar on the main unit through the jar base.
4. Put the ingredients to be processed in the jar.
5. Fix the appropriate jar lid firmly on the jar ensuring that the lid has locked in securely from all side.
6. The Mixer & Grinder can now be plugged in and is ready to use.
7. Use speed control knob and move gradually from lower to higher speeds. After use, unplug the Mixer & Grinder.

Instruction to use the Mixer & Grinder

To use the Mixer & Grinder for the first time or after a long period of non-usage:

- After unpacking the mixer grinder, wash the jars and blades with mild detergent and dry it thoroughly.
 - Please rotate the motor shaft by hand to ensure that it turns freely & smoothly. Make sure the unit is not connected to the power source.
 - Before fixing the jar to the main unit, rotate the jar coupler to ensure that it turns freely onto the aluminium jar base that has to be fitted onto the main unit. Hold the base and rest it on the main unit.
 - Plug the mains cord in the wall socket & switch the power ON.
 - Do not touch the jar with bare hands immediately after using the mixer.
- The speed of operations is marked with circular dots in increasing order of speed. Pulse shall be used for momentary operation.

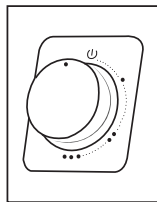

NOTE: Pictorial representation illustrated in the user manual are indicative only, parts provided with the product may differ with illustrations.

WARNING: Do not run the mixer & grinder unless lid is in place and held firmly with hand.

Instruction to use Chutney Jar

This jar can be used to grind small quantities of jeera, dhania, coconut, green chilli, pepper, garam masala and other dry spices.

Put the ingredients to be ground in the chutney jar.

Blades and their Functions

(1) **Hardened stainless steel universe grinding blade:** To be primarily used for wet as well as dry grinding. The blade can also be used for liquidising and grating functions.

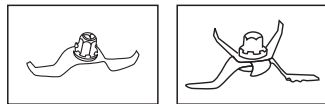

(2) **Stainless steel liquidising blade:** For blending and liquidising.

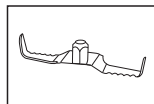

(3) **Stainless steel chutney grinding blade:** For grinding chutney and small quantity of spices.

How to care for your Mixer & Grinder

Warning: Be sure to switch 'OFF' your Mixer & Grinder after use. Wait until the blades come to a halt before removing the cover.

- After each use it is highly desirable to wash & thoroughly clean the jar blade and the lids.
- First, remove the main plug from the wall socket. Gently detach the jar from the main unit.
- Open the lid & empty the contents.
- To remove the blade assembly, use a spoon to stop the blade from rotating and use a spatula to gently loosen/unscrew the plastic dome nut of blade assembly in clockwise direction. The jar can be cleaned using some warm soapy water. Then rinse with cleanwater & wipe dry with a soft damp cloth. Do not keep the jar immersed in water.
- Do not immerse the main unit in water. The main unit be cleaned using a damp doth
- Cleaning is easy & best done immediately after use.
- Do not operate or touch the unit when smoke/burnt smell is observed. Contact the authorized SHARP Service Centre.

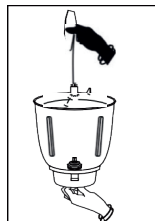

Overload Protection (OLP)

- The OLP is designed to protect your motor from burning.
- When the jar is filled more than what is specified or the liquid is too viscous, the OLP trips and the motor stops automatically.
- When this happens, reduce the quantity of material being ground or add some water.
- To restart, press the OLP button located at the bottom on the mixer.
- Wait for a while and then start your Mixer & Grinder again.

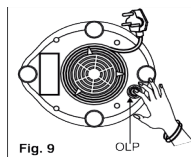

Fig. 9

Technical Data

Series	PureBlend - Flavours Of Perfection					
Model	EM-G71N-M	EM-JG71N-G	EM-JG71N-B	EM-G101N-M	EM-JG101N-G	EM-JG101N-B
Wattage	750W- Copper	750W- Copper	750W- Copper	1000W- Copper	1000W- Copper	1000W- Copper
RPM	20,000	20,000	20,000	21,000	21,000	21,000
Voltage	230 VAC, 50 Hz	230 VAC, 50 Hz	230 VAC, 50 Hz	230 VAC, 50 Hz	230 VAC, 50 Hz	230 VAC, 50 Hz
Motor Rating	"30 Mins (5 min On, 2 min Off)"	"30 Mins (5 min On, 2 min Off)"	"30 Mins (5 min On, 2 min Off)"	"30 Mins (5 min On, 2 min Off)"	"30 Mins (5 min On, 2 min Off)"	"30 Mins (5 min On, 2 min Off)"
Protection Class	Class I	Class I	Class I	Class I	Class I	Class I
Insulation Class	F	F	F	F	F	F
Power Cord	3pin 3 core	3pin 3 core	3pin 3 core	3pin 3 core	3pin 3 core	3pin 3 core
Blending Jar	•	✓	✓	•	✓	✓
Wet Grinding Jar	✓	✓	✓	✓	✓	✓
Dry Grinding Jar	✓	✓	✓	✓	✓	✓
Chutney Grinding Jar	✓	✓	✓	✓	✓	✓
Shaker	•	•	✓	•	•	✓
Spatula	✓	✓	✓	✓	✓	✓

Trouble Shooting Guide

Note: In case the following measures do not work, please take the Mixer and Grinder to the nearest authorized SHARP service centre.

PROBLEM	CAUSE	CORRECTIVE ACTION
The mixer does not start	No power supply	Ensure Power Supply
	Tripped due to overload	Switch off the supply. Remove excess load and reset the OLP located at the bottom of the mixer base. (If it still does not work contact SHARP call centre.
The result/ performance is unsatisfactory	Overloading	Fill the chutney jar up to the level of blades & the other 2 jars up to capacity level indicated.
Mixer generates abnormal noise	Size of ingredients not proper	Cut/ Break down the ingredients to be grounded into appropriate size.
	Wrong Jar/Blade used	Ensure that you are using the jar/ blade for its right/ intended purpose
	Jar is not locked properly	Lock the jar properly
	Blade assembly is loose	Tighten dome nut of blade assembly properly.
	Coupler loose	Tighten Coupler

Jar Capacity

No	Type of Jar	Capacity	Wet Capacity (rated) max.	Dry Capacity (rated) max.	Chutney Capacity (rated) max.
1.	Wet grinding jar	1.50 L	0.6L	NA	NA
2.	Dry grinding jar	1.0 L	NA	0.5L	NA
3.	Chutney grinding jar	0.4 L	NA	NA	0.2L

ENVIRONMENTALLY FRIENDLY DISPOSAL

IF YOU WISH TO DISPOSE OF THIS EQUIPMENT, DO NOT USE THE ORDINARY WASTE BIN AND DO NOT PUT THEM INTO A FIREPLACE!

Used electrical and electronics equipment should always be collected and treated SEPARATELY In accordance with law.

Separate collection promotes an environment-friendly treatment, recycling of materials, and minimizing final disposal of waste. IMPROPER DISPOSAL can be harmful to human health and the environment due to contained hazardous substances!

Take USED EQUIPMENT to a nearby collection center/point.

If in doubt, call us on our toll-free number: 1800-419-4322 and ask for the correct method of disposal.

This equipment complies with the E-Waste (Management) Rule, 2022: This product complies with the RoHS standard as specified in rule 16 of EWM Rules 2022.

For more information to recycle properly, please visit the website: in.sharp



TERMS & CONDITIONS OF WARRANTY

SHARP warrants all new products manufactured by It to be free from defects in material and workmanship under normal usage and service from the date of purchase as under:

1. 2 year comprehensive warranty on product and 5 year warranty on motor.
2. The warranty period commences from date of purchase by the first end user. During this warranty period of 2 years, SHARP or its authorized service provide (ASP) will repair the product that in the opinion of the SHARP or its authorized provider is defective in operation due to faulty material or workmanshi (i.e., manufacturing defect)with the exception of accessories.
3. The product's plastic items & accessories are not covered under Warranty and hence must be handled with care to guard against breakage.
4. This Warranty is void if the unit is not operated under normal conditions or according to the Instructions given In the manual.
5. Product returned to SHARP or Its Authorized Dealer for Warranty examination must be shipped freight prepaid.
6. SHARP or its Authorized Dealer shall not be held liable for claims exceeding the cost of the product.
7. This Warranty Agreement shall not be Interpreted to render SHARP or its Authorized Dealer liable for injuries or damages of any kind direct, consequential or contingent to persons or property.
8. SHARP, It's Authorized Dealer or ASP shall not be held responsible by representative or buyer tor failure to abide by any of the obligations of this Warranty Agreement, If such failures are the result of circumstances of Forces Majeures such as (but not limited to) floods, earthquakes, transportation strikes, labour disputes with outside suppliers or any other conditions beyond the control of SHARP or its Authorized Dealer.
9. SHARP, It's Authorized Dealer or ASP shall not be held liable for repair or alterations made without prior written approval for product failures resulting from the lack of proper maintenance.

10. This Warranty Agreement excludes all products/component parts or damage to any part of this SHARP product which, In the opinion of SHARP, It's Authorized Dealer or ASP have been subjected to misuse, misapplication, negligence, alteration, accident or operation, contrary to our instructions, Incompatibility with accessories not Installed by SHARP, It's Authorized Dealer or ASP or that have been repaired with component parts other than those manufactured by or obtained from SHARP, It's Authorized Dealer or ASP. Damage caused by freezing, flood, fire or Act of God is not covered by this Warranty. In all such cases, regular charges will apply. This limited Warranty does not include service to diagnose a claimed malfunction in this unit. The warranty will not apply if the serial number has been removed or defaced from the product.
11. SHARP reserves the right to alter or improve design and specifications at any time, without any contingent obligations to prospective buyers or owners of the products previously sold.
12. Any disagreements and obligations based upon the purchase of SHARP products and thereby imposed on SHARP, It's Authorized Dealer or Authorised Service Providers (ASP) shall be governed by and construed according to the laws of INDIA and subject to the jurisdiction of Delhi courts only.
13. SHARP, It's Authorized Dealer or ASP assumes no Warranty liability in connection with this SHARP Mixer & Grinder other than that specified herein. This Warranty Is in lieu of all other warranties, expressed or implied, including warranties of fitness for a particular purpose. SHARP or its Authorized Dealers does not authorize any person or representative to assume for them any other obligations on the sale of this appliance.
14. Under no circumstances, the Liability of SHARP, It's Authorized Dealer or ASP shall exceed the value of the product.
15. Under no circumstances are the terms mentioned above negotiable and no employee of SHARP, It's Authorized Dealer or ASP has the authority to supersede them.

WARRANTY CARD

PRODUCT-SHARP MIXER GRINDER

Serial number of units:.....

CUSTOMER DETAILS

Name:.....

Address:.....

Mobile No:.....E-mail:.....

SELLER'S DETAILS

Seller's Name (Company).....

Invoice No:..... Invoice Date.....

REGISTER YOUR PRODUCT

For quick & efficient service support,
Please call **1800 419 4322** and register your Mixer & Grinder
Alternatively you can give a missed call at 9804 763 763 or
email above details to **support @sharp-oa.com**



SHARP

Be Original.

SHARP Business Systems
(India) Private Limited
3rd Floor, Add India Centre,
Plot No.9, Sector 125, Noida
ZIP-code 201301.



/SHARPSmartSolu1



/Sharpsmartappliances/
/Sharpsmartbusiness/



/sharp_smartappliances/
/sharp_smartbusiness/



/@Sharp_India?si=p8zeNzZ7Tzu1GBF1